

REVISED DEVELOPMENT PLAN OF MATHERAN (SECOND REVISION)
PROPOSED LAND USE PLAN (DETAIL PLAN FOR BAZAR PLOT AREA)
MODIFICATION OF SUBSTANTIAL NATURE
(E.P.) SANCTIONED UNDER 31 (1) OF M.R. & T.P. ACT, 1966

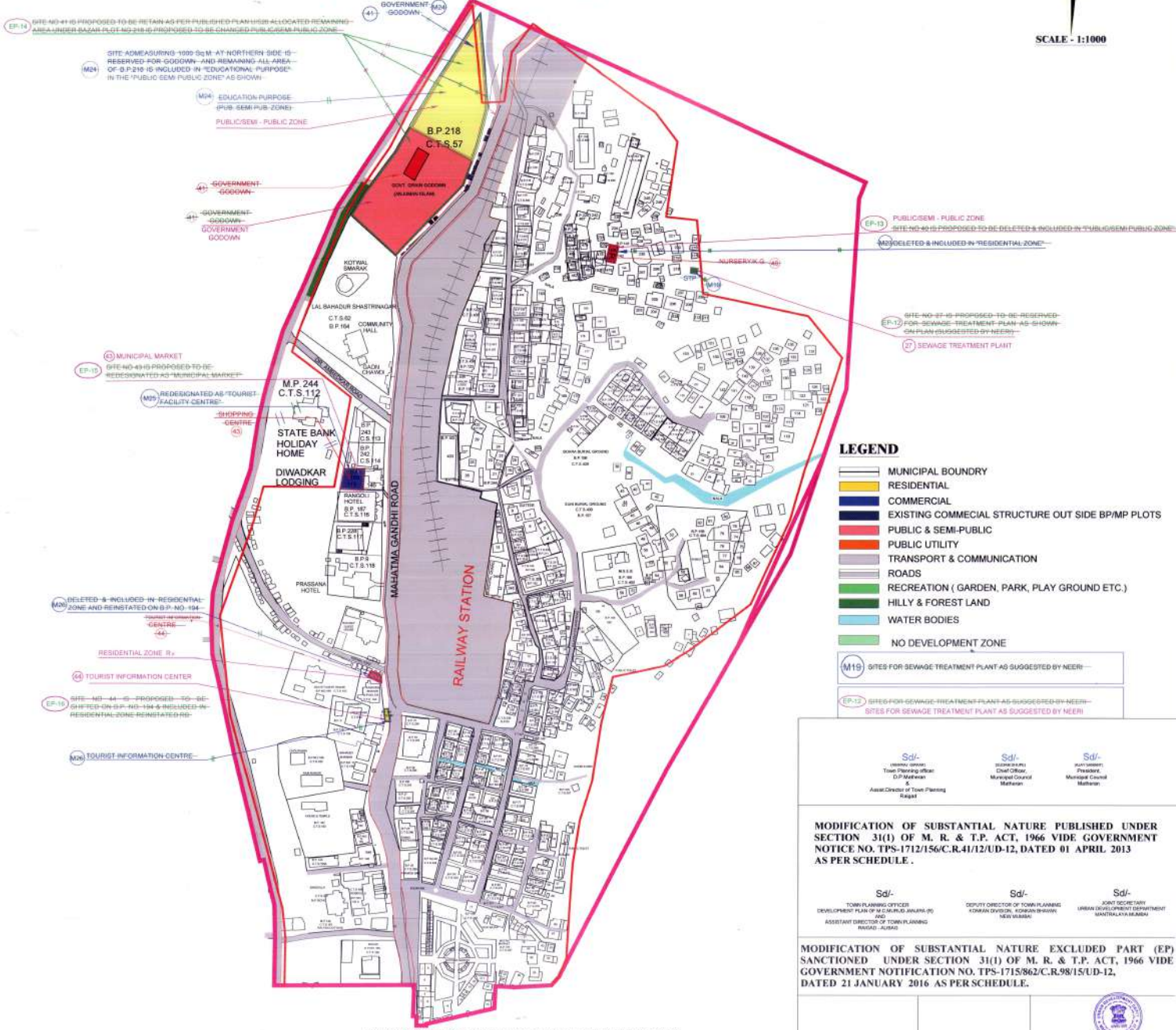

- LEGEND**
- MUNICIPAL BOUNDARY
 - RESIDENTIAL
 - COMMERCIAL
 - EXISTING COMMERCIAL STRUCTURE OUT SIDE B/P/M PLOTS
 - PUBLIC & SEMI-PUBLIC
 - PUBLIC UTILITY
 - TRANSPORT & COMMUNICATION
 - ROADS
 - RECREATION (GARDEN, PARK, PLAY GROUND ETC.)
 - HILLY & FOREST LAND
 - WATER BODIES
 - NO DEVELOPMENT ZONE
- M19 SITES FOR SEWAGE TREATMENT PLANT AS SUGGESTED BY NEER
- EP-12 SITES FOR SEWAGE TREATMENT PLANT AS SUGGESTED BY NEER

Sd/-
 MEMBER, JMW
 Town Planning Officer
 Chief Officer
 Municipal Council
 Matheran
 Asstt. Director of Town Planning
 Rajat

Sd/-
 MEMBER, JMW
 Chief Officer
 Municipal Council
 Matheran

Sd/-
 MEMBER, JMW
 President
 Municipal Council
 Matheran

MODIFICATION OF SUBSTANTIAL NATURE PUBLISHED UNDER SECTION 31(1) OF M. R. & T.P. ACT, 1966 VIDE GOVERNMENT NOTICE NO. TPS-1712/156/C.R.41/12/UD-12, DATED 01 APRIL 2013 AS PER SCHEDULE .

Sd/-
 TOWN PLANNING OFFICER
 DEVELOPMENT PLAN OF M.C. MUNICIPAL ANARA (P)
 JMD
 ASSISTANT DIRECTOR OF TOWN PLANNING
 RAJAT AGROD

Sd/-
 DEPUTY DIRECTOR OF TOWN PLANNING
 FORAN DIVISION, KOLHAPUR DIVISION
 NARAYAN KHOSLA

Sd/-
 JOINT SECRETARY
 URBAN DEVELOPMENT DEPARTMENT
 MANTALAYA, MUMBAI

MODIFICATION OF SUBSTANTIAL NATURE EXCLUDED PART (EP) SANCTIONED UNDER SECTION 31(1) OF M. R. & T.P. ACT, 1966 VIDE GOVERNMENT NOTIFICATION NO. TPS-1715/862/C.R.98/15/UD-12, DATED 21 JANUARY 2016 AS PER SCHEDULE.

- MODIFICATIONS SHOWN AS PER PLAN SUBMITTED UNDER SECTION 30 OF M.R. & T.P. ACT, 1966.
- EXCLUDED PART PUBLISHED UNDER SECTION 31(1) OF M. R. & T.P. ACT, 1966.
- EXCLUDED PART SANCTIONED UNDER SECTION 31(1) OF M. R. & T.P. ACT, 1966.

PREPARED BY: *[Signature]*
 CHECKED BY: *[Signature]*

TOWN PLANNING OFFICER
 DEVELOPMENT PLAN OF M.C. MUNICIPAL ANARA
 ASSISTANT DIRECTOR OF TOWN PLANNING
 RAJAT AGROD

JOINT DIRECTOR OF TOWN PLANNING
 ANARA DIVISION
 NARAYAN KHOSLA

180
 MUNICIPAL ENGINEER
 MANTALAYA, MUMBAI